



2 Fire Station Square, Salford, M5 4NZ

Jordan Fishwick are pleased to offer for sale this charming three storey townhouse is located in the grounds of a former fire station just off Chapel Street, ideal for access to both Manchester city centre and Salford Quays. This period property comprises of a spacious dining area which has been opened up to the living room creating one large reception room, kitchen with a range of appliances and a rear yard. The first floor offers two good sized bedrooms and a family bathroom whilst the second floor offers a further spacious bedroom. Driveway to the front plus additional residents permit parking. Freehold. Council Tax Band D.

Price £350,000

Viewing arrangements

Viewing strictly by appointment through the agent

245 Deansgate, Manchester, M3 4EN 0161 833 9499 opt 3

Dining Room

13'6" x 13'1"

Wooden flooring. Ceiling light. Radiator. Fireplace.

Living Room

13'8" x 13'1"

Wooden flooring. Ceiling light. Radiator. Doors leading to yard.

Kitchen

6'6", 298'6" x 7'8"

Range of wall and base units with worktops over. Sink with mixer tap. Integrated fridge/freezer and dishwasher. Freestanding dishwasher. Cooker with hob and extractor over. Laminate flooring. Door to yard.

Bedroom One (Loft Room)

14'0" x 13'1"

Fitted carpet. Ceiling light. Radiator.

Bedroom Two

Laminate flooring. Ceiling light. Radiator. Fitted wardrobes.

Bedroom Three

Laminate flooring. Ceiling light. Radiator. Fitted wardrobes.

Bathroom

Low level W/C. Bath with mixer tap. Shower cubical with electric shower. Sink with mixer tap and vanity unit. Spotlights.

Externally

Yard to rear. Driveway. Additional residents parking available.

Additional Information

Lease -

Ground rent - None payable

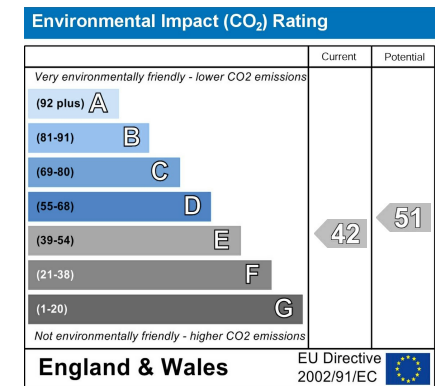
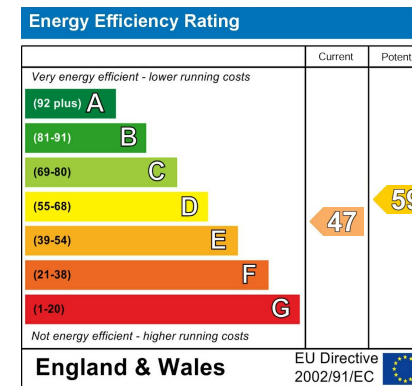



GROUND FLOOR



1ST FLOOR



2ND FLOOR

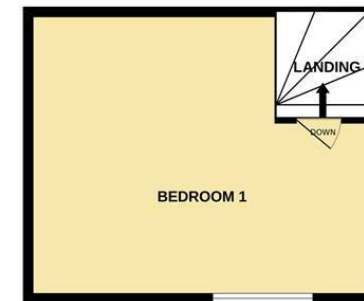

Measurements are approximate. Not to scale. Illustrative purposes only
Made with Metropix ©2023



These particulars are believed to be accurate but they are not guaranteed and do not form a contract. Neither Jordan Fishwick nor the vendor or lessor accept any responsibility in respect of these particulars, which are not intended to be statements or representations of fact and any intending purchaser or lessee must satisfy himself by inspection or otherwise as to the correctness of each of the statements contained in these particulars. Any floorplans on this brochure are for illustrative purposes only and are not necessarily to scale.

Offices at: Chorlton, Didsbury, Disley, Hale, Glossop, Macclesfield, Manchester Deansgate, Manchester Whitworth Street, New Mills, Sale, Wilmslow and Withington

245 Deansgate, Manchester, M3 4EN

0161 833 9499 opt 3

manchester@jordanfishwick.co.uk

www.jordanfishwick.co.uk

